



## Solano County Special Education Local Plan Area

**Participants:**  
Benicia Unified School District  
Dixon Unified School District  
Fairfield-Suisun Unified School District  
Travis Unified School District  
Vacaville Unified School District  
Solano County Office of Education

### SELPA Governance and Finance Committee

Wednesday, May 18, 2022

9:00 – 11:00 a.m.

SCOE – Waterman Conference Room

- |  |             |
|--|-------------|
| 1. Call to Order & Roll Call   | Action      |
| 2. Approve Agenda  | Action      |
| 3. Approve Meeting Minutes from April 28, 2022   | Action      |
| 4. Public Comment<br>Members of the public wishing to address any item listed on the agenda are asked to submit a Request to Speak form to the Assistant Superintendent of the SELPA at the opening of the meeting. Speakers are requested to limit their comments to three (3) minutes. Public comment will be limited to a combined total of 15 minutes. |             |
| 5. SELPA Reports   |             |
| 5.1. Nonpublic School (NPS) Expenditure Update   | Information |
| 5.2. Mental Health as a Related Service (MHRS) Pool Update   | Information |
| 5.3. Legal Pool Update   | Information |
| 5.4. Legal Education Fund Update   | Information |
| 5.5. SELPA Funding Allocations   | Information |
| 6. SELPA Business  |             |
| 6.1. California Children's Services (CCS) – Medical Therapy Unit (MTU)   | Information |
| 6.2. Learning Recovery Support Plan and Dispute Prevention/Dispute Resolution (ADR) Plan   | Discussion  |
| 6.3. 2022-23 Annual Budget Plan & Annual Service Plan  | Information |
| 6.4. SELPA Procedural Manual – Section R: SCOE Regional Programs   | Action      |
| 6.5. Recommendation on June 15, 2022 Meeting   | Action      |
| 7. SCOE Reports  |             |
| 7.1. 2022-23 SCOE Transportation Budget  | Information |
| 8. Adjournment   |             |

Next Meeting: **Wednesday, June 15, 2022**

In compliance with the Americans with Disabilities Act, for those requiring special assistance to access SELPA public meetings, to access written documents being discussed at the meetings, or to otherwise participate at SELPA public meetings, please contact the SELPA office at (707) 399-4460. Notification at least 72 hours prior to the meeting will enable the SELPA to make reasonable arrangements to ensure accessibility to the meeting and to provide any required accommodations, auxiliary aids, or services.

Any writings or documents that are public records and are provided to the SELPA Governance and Finance Committee regarding an item on this agenda will be made available for public inspection in the Solano County SELPA office located at 5100 Business Center Dr., Fairfield, CA, during normal business hours. In addition, such writings and documents may be posted on the SELPA's website at [www.SolanoCountySELPA.net](http://www.SolanoCountySELPA.net)

**SELPA Governance and Finance Committee  
April 27, 2022  
Minutes**

**1. Call to Order & Roll Call:** Andrew Ownby called the meeting to order at 9:00 a.m.

**Members Present:**

Solano County SELPA: Andrew Ownby, Russ Barrington  
Benicia USD: Julie Corona  
Dixon USD: Kim Parrott, Trudy Barrington  
Fairfield-Suisun USD: Laneia Grindle, Stavros Gougoumis  
Solano COE: Siobhan Dill, Becky Lentz  
Travis USD: Deanna Brownlee  
Vacaville USD: Karine Fickes

**2. Approval of Agenda**

Move to approve the agenda.  
Motion by Kim Parrott, second by Trudy Barrington  
Final Resolution: Motion carries  
Yes: Julie Corona, Kim Parrott, Laneia Grindle, Stavros Gougoumis, Siobhan Dill, Deanna Brownlee, Becky Lentz and Karine Fickes

**3. Approval of Minutes from February 16, 2022**

Move to approve minutes.  
Motion by Kim Parrott, second by Siobhan Dill  
Final Resolution: Motion Carries  
Yes: Julie Corona, Kim Parrott, Laneia Grindle, Stavros Gougoumis, Siobhan Dill, Deanna Brownlee, Becky Lentz and Karine Fickes

**4. Public Comment** – No public comment.

**5. SELPA Reports**

**5.1. Nonpublic School (NPS) Expenditure Update** –Information item. No questions or concerns were reported.

**5.2. Mental Health as a Related Service (MHRS) Pool Update** – Information item. No questions or concerns were reported.

**5.3. Legal Pool Update** – Russ Barrington requested the districts submit any outstanding legal pool invoices. No questions or concerns were reported.

**5.4. Legal Education Fund Update** – Information item. No questions or concerns were reported.

**5.5. SELPA Funding Allocations** – Information item. No questions or concerns were reported.

**6. SELPA Business**

**6.1. California Children’s Services – Medical Therapy Unit (CCS MTU)** – Andrew Ownby reported that the progress on the medical therapy unit is going well. Russ Barrington reported that a total of \$875,000 in revenue was held to complete the renovation. It is expected that the full amount will be expended for this project. No questions or concerns were reported.

**6.2. SELPA Procedural Manual, Section R-SCOE Regional Programs:** This item was on the agenda as an action item; however, it was tabled until next month as the group asked for some clarification to be added in certain areas.

**6.3. Approval of 2022-2023 Meeting Schedule**

Move to approve the 2022-2023 Meeting Schedule with the change of the October meeting being on the 19<sup>th</sup>.

Motion by Karine Fickes, second by Stravos Gougoumis

Final Resolution: Motion carries

Yes: Julie Corona, Kim Parrott, Laneia Grindle, Stavros Gougoumis, Siobhan Dill, Karine Fickes, Becky Lentz and Deanna Brownlee

**6.4. Transportation Study Update** – Andrew Ownby reported that Pupil Transportation Information (PTI) consultants had concluded **their** study. A copy of the study and recommendations was provided in the packet. Andrew pointed out that the report noted that SCOE’s funding for the transition transportation program comes from the special education department rather than the transportation department. As the program transports students to and from their work or job sites, this would be a legitimate transportation expense that has never been a part of the SCOE transportation program.

**7. SCOE Reports**

**7.1. Special Education Financial Report** – Becky Lentz reported that the reports provided in the packet reflect the actuals through March. No questions or concerns were reported.

**8. Adjournment** – The meeting was adjourned at 9:20 a.m.

Minutes submitted by Rayna Ortiz and were reviewed by Russ Barrington and Andrew Ownby.

<b>2021-2022 NPS FUND UPDATE - May 2022 Meeting</b>			
<b><u>Expenditures:</u></b>	<b>21/22 Budget</b>	<b>5/11/2022</b>	<b>Projected as of 6/30/22</b>
Non-Public School (NPS):	6,267,367	4,267,111	5,833,965
Parent Visitations (per IEP):	1,000	-	-
<b>TOTAL:</b>	<b>6,268,367</b>	<b>4,267,111</b>	<b>5,833,965</b>
<b><u>Direct District Contribution:</u></b>			
BUSD	203,552	80,283	92,731
DUSD	307,067	538,500	636,901
FSUSD	2,889,100	1,750,625	2,356,866
TUSD	874,511	579,673	799,350
VUSD	1,994,137	1,552,577	1,948,117
	<b>6,268,367</b>	<b>4,501,658</b>	<b>5,833,965</b>
<b>** Direct District Contribution is charged back to districts based on actual usage.</b>			

## 2021-2022 MHRS POOL UPDATE - May 2022 Meeting

Revenues & Fund Balance:	21/22 Budget	Projected as of 6/30/22	
20/21 Ending Balance - 6512	238,735		238,735
20/21 Ending Balance - 6546	14,163		14,163
20/21 CARE Clinic Development (ending balance)	1,108,975		1,108,975
<i>Subtotal:</i>	<i>1,361,873</i>		<i>1,361,873</i>
21/22 IDEA MH (RS 3327) Award	532,113		532,113
21/22 AB114 (RS 6512) Award	3,056,827		3,056,827
<i>Subtotal:</i>	<i>3,588,940</i>		<i>3,588,940</i>
<b>TOTAL:</b>	<b>4,950,813</b>		<b>4,950,813</b>

<u>Expenditures:</u>	21/22 Budget	5/11/2022	Projected as of 6/30/22
21/22 - CARE Clinic Non-medicare Eligible	500,000	31,163	100,000
<i>Subtotal:</i>	<i>500,000</i>	<i>31,163</i>	<i>100,000</i>
District MH Allocation (RS 6512/6546)	2,979,725	2,163,718	2,979,725
District MH Allocation (RS 3327)	532,113	-	532,113
SCOE JDF MH	30,000	9,459	30,000
SELPA MH Expenses	-	-	-
Residential Placements (2 placements)	300,000	-	-
<i>Subtotal:</i>	<i>3,841,838</i>	<i>2,173,177</i>	<i>3,541,838</i>
<b>TOTAL:</b>	<b>4,341,838</b>	<b>2,204,340</b>	<b>3,641,838</b>

<i>Projected Ending Balance:</i>	1,308,975
21/22 CARE Clinic Ending Balance	1,008,975
21/22 Undesignated Fund Balance	300,000

## Mental Health as a Related Service

2021 - 2022

### Sierra School of Solano County

Current Students		5/11/2022	End of Year Estimate
<b>BUSD</b>			
0	Day Treatment	-	-
0	Residential Placement	-	-
		\$ -	\$ -
<b>DUSD</b>			
2	Day Treatment	28,825.41	38,337.80
0	Residential Placements	-	-
		\$ 28,825.41	\$ 38,337.80
<b>FSUSD</b>			
8	Day Treatment	133,801.53	177,956.03
0	Residential Placements	-	-
		\$ 133,801.53	\$ 177,956.03
<b>SCOE - JDF</b>			
0	Outpatient	-	-
		\$ -	-
<b>TUSD</b>			
4	Day Treatment	23,089.01	39,251.32
0	Residential Placements	-	-
		\$ 23,089.01	39,251.32
<b>VUSD</b>			
4	Day Treatment	61,953.12	82,397.65
0	Residential Placements	-	-
		\$ 61,953.12	\$ 82,397.65
<b>Expenditures:</b>		\$ 247,669.07	\$ 337,942.80

Repayments to pool:	\$ 214.00	\$ -	\$ 529.00	\$ 689.00	\$ 1,099.00	\$ -	\$ 2,531.00
SELPA distribution to LEAs per 19-20 ADA%:	\$ 549.57	\$ 361.08	\$ 2,513.67	\$ 655.32	\$ 1,533.42	\$ -	
Total usage of pool:	\$ 8,374.57	\$ 2,711.08	\$ 20,802.67	\$ 30,585.32	\$ 21,110.42	\$ -	\$ 83,584.06
<b>Percent of pool usage:</b>	<b>10.02%</b>	<b>3.24%</b>	<b>24.89%</b>	<b>36.59%</b>	<b>25.26%</b>	<b>0.00%</b>	\$ 86,115.06

**TOTAL REMAINING:           \$ 215,655.00**

**2021-2022 Legal Education Breakdown by District - Fagen Friedman & Fulfrost (FFF)****Solano County SELPA**

Date	Month	Monthly Contract	SELPA	BUSD	DUSD	FSUSD	TUSD	VUSD	SCOE	Total hours used by month	Hours Remaining
2021-2022 Annual Cost		\$ 38,400.00									
			<b>160 Hours</b>								
7/31/21	July	\$ 3,200.00	2.30	3.90	-	2.40	0.10	0.70	-	9.40	150.60
8/31/21	August	\$ 3,200.00	7.80	3.20	-	3.80	3.00	0.30	-	18.10	132.50
9/30/21	September	\$ 3,200.00	12.20	3.10	-	1.80	1.80	-	-	18.90	113.60
10/31/21	October	\$ 3,200.00	7.30	1.20	-	-	0.70	-	-	9.20	104.40
11/30/21	November	\$ 3,200.00	0.30	1.10	0.90	1.10	2.00	0.70	0.20	6.30	98.10
12/31/21	December	\$ 3,200.00	0.90	1.10	1.70	1.00	1.10	0.20	0.70	6.70	91.40
1/31/22	January	\$ 3,200.00	0.40	0.70	-	4.20	0.80	-	-	6.10	85.30
2/28/22	February	\$ 3,200.00	3.40	2.10	-	1.30	0.20	-	-	7.00	78.30
3/31/22	March	\$ 3,200.00	3.30	5.00	3.10	0.30	4.70	0.20	-	16.60	61.70
										-	61.70
										-	
		<b>Total</b>	\$ 28,800.00	37.90	21.40	5.70	15.90	14.40	2.10	0.90	98.30
		<i>Usage of hours to Date</i>		38.56%	21.77%	5.80%	16.17%	14.65%	2.14%	0.92%	



## 2021 / 2022 SELPA Allocations

5/11/2022

			IDEA	IDEA - ARP	IDEA Preschool	IDEA Preschool - ARP	IDEA MHRS	AB602	AB114 - 6546	AB114 - 6512
<b>Revenue:</b>										
Revenue			\$ 9,397,766	\$ 1,850,788	\$ 348,854	\$ 158,569	\$ 532,113	\$ 34,646,559	\$ 3,056,827	
<b>Deductions :</b>										
SCOE Direct Allocation			(1,017,962)					(20,233,579)	(30,000)	
Pooled Allocations								(1,649,239)	(1,394,812)	\$ 1,347,710
SELPA Allocation								(1,464,189)		
			\$ 8,379,804	\$ 1,850,788	\$ 348,854	\$ 158,569	\$ 532,113	\$ 11,299,552	\$ 1,632,015	\$ 1,347,710
DISTRICT	19/20 Annual ADA	% of Total ADA	District Allocation IDEA (3310)	District Allocation IDEA (3305)	District Allocation Preschool (3315)	District Allocation IDEA (3308)	District Allocation IDEA MHRS (3327)	District Allocation AB602 (6500)	District Allocation AB 114 (6546)	District Allocation AB 114 (6512)
BUSD	4,422.88	9.79%	820,444	181,206	34,155	15,525	52,098	1,106,308	159,786	131,951.00
DUSD	2,905.85	6.43%	539,035	119,053	22,440	10,200	34,228	726,849	104,980	86,692.00
FSUSD	20,230.33	44.78%	3,752,724	828,837	156,227	71,012	238,297	5,060,274	730,865	603,543.84
TUSD	5,274.19	11.68%	978,362	216,084	40,730	18,513	62,125	1,319,249	190,542	157,348.00
VUSD	12,340.92	27.32%	2,289,239	505,608	95,302	43,319	145,365	3,086,872	445,842	368,175.00
Total:	45,174.17	100%	8,379,804	1,850,788	348,854	158,569	532,113	11,299,552	1,632,015	1,347,709.84

# California Children's Services Medical Therapy Unit B. Gale Wilson Site Remodel as of 5/11/2022

- Revenue
  - AB602 – Off the Top
    - 2021 - \$450,000
    - 2022 - \$425,000
- Total Revenue - \$875,000

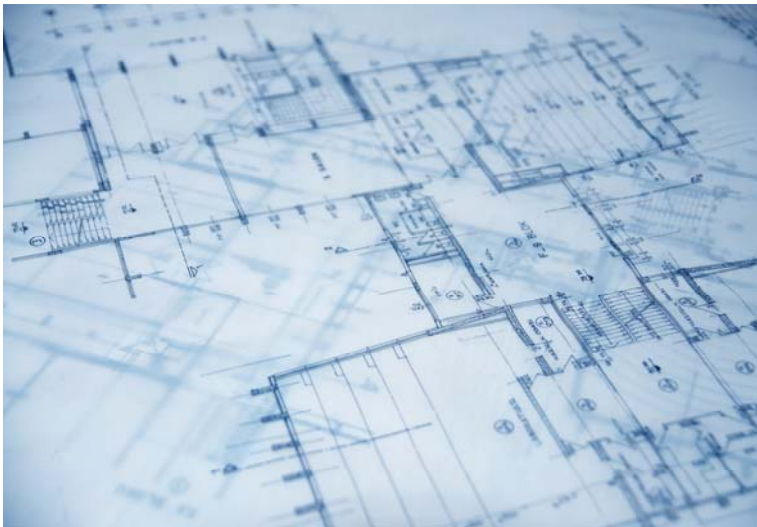

- Expenses
  - Rent
    - 2021 - \$14,079
    - 2022 - \$24,148
  - Supplies
    - 2021 - \$194
    - 2022 - \$5,248
  - Construction Management
    - 2021 - \$51,628
    - 2022 - \$20,874
  - Construction
    - 2022 - \$556,178
  - Moving Expenses
    - 2022 - \$3,190
  - Indirect Costs
    - 2021 - 3,295
- Total Expenses - \$678,834

Special Education Local Plan Area (SELPA) Local Plan

SELPA Solano County SELPA

Fiscal Year 2022–23

## **LOCAL PLAN**

### **Section D: Annual Budget Plan**

#### **SPECIAL EDUCATION LOCAL PLAN AREA**

California Department of Education

Special Education Division

2022–23 Local Plan Submission

## Section D: Annual Budget Plan

SELPA Solano County SELPA

Fiscal Year 2022–23

### Local Plan Section D: Annual Budget Plan

Projected special education budget funding, revenues, and expenditures by LEAs are specified in **Attachments II–V**. This includes supplemental aids and services provided to meet the needs of students with disabilities as defined by the Individuals with Disabilities Education Act (IDEA) who are placed in regular education classrooms and environments, and those who have been identified with low incidence disabilities who also receive special education services.

**IMPORTANT:** Adjustments to any year’s apportionment must be received by the California Department of Education (CDE) from the SELPA prior to the end of the first fiscal year (FY) following the FY to be adjusted. The CDE will consider and adjust only the information and computational factors originally established during an eligible FY, if the CDE's review determines that they are correct. California *Education Code (EC)* Section 56048

Pursuant to *EC* Section 56195.1(2)(b)(3), each Local Plan must include the designation of an administrative entity to perform functions such as the receipt and distribution of funds. Any participating local educational agency (LEA) may perform these services. The administrative entity for a multiple LEA SELPA or an LEA that joined with a county office of education (COE) to form a SELPA, is typically identified as a responsible local agency or administrative unit. Whereas, the administrative entity for single LEA SELPA is identified as a responsible individual. Information related to the administrative entity must be included in Local Plan Section A: Contacts and Certifications.

## Section D: Annual Budget Plan

SELPA Solano County SELPA

Fiscal Year 2022–23

**TABLE 1**

## Special Education Projected Revenue Reporting (Items D-1 to D-3)

## D-1. Special Education Revenue by Source

Using the fields below, identify the special education projected revenue by funding source. The total projected revenue and the percent of total funding by source is automatically calculated.

Funding Revenue Source	Amount	Percentage of Total Funding
Assembly Bill (AB) 602 State Aid	28,254,252	58.80%
AB 602 Property Taxes	6,392,307	13.30%
Federal IDEA Part B	9,746,620	20.28%
Federal IDEA Part C	47,966	0.10%
State Infant/Toddler	0	0.00%
State Mental Health	3,056,827	6.36%
Federal Mental Health	532,113	1.11%
Other Projected Revenue	20,777	0.04%
<b>Total Projected Revenue:</b>	<b>48,050,862</b>	<b>100.00%</b>

## D-2. "Other Revenue" Source Identification

Identify all revenue identified in the "Other Revenue" category above, by revenue source, that is received by the SELPA specifically for the purpose of special education, including any property taxes allocated to the SELPA pursuant to *EC* Section 2572. *EC* Section 56205(b)(1)(B)

Preschool - \$3,000, ADR - \$17,777

## D-3. Attachment II: Distribution of Projected Special Education Revenue

Using the form template provided in **Attachment II**, complete a distribution of revenue to all LEAs participating in the SELPA by funding source.

## Section D: Annual Budget Plan

SELPA Solano County SELPA

Fiscal Year 2022–23

**TABLE 2****Total Projected Budget Expenditures by Object Code (Items D-4 to D-6)****D-4. Total Projected Budget by Object Code**

Using the fields below, identify the special education expenditures by object code. The total expenditures and the percent of total expenditures by object code is automatically calculated.

Object Code	Amount	Percentage of Total Expenditures
Object Code 1000—Certificated Salaries	43,884,375	30.17%
Object Code 2000—Classified Salaries	35,051,210	24.09%
Object Code 3000—Employee Benefits	36,840,004	25.32%
Object Code 4000—Supplies	1,818,306	1.25%
Object Code 5000—Services and Operations	24,123,560	16.58%
Object Code 6000—Capital Outlay	400,000	0.27%
Object Code 7000—Other Outgo and Financing	3,356,990	2.31%
<b>Total Projected Expenditures:</b>	<b>145,474,445</b>	<b>100.00%</b>

**D-5. Attachment III: Projected Local Educational Agency Expenditures by Object Code**

Using the templates provided in **Attachment III**, complete a distribution of projected expenditures by LEAs participating in the SELPA by object code.

**D-6. Code 7000—Other Outgo and Financing**

Include a description for the expenditures identified under object code 7000:

Debt Service - \$31,542, Indirect Costs - \$3,325,448

## Section D: Annual Budget Plan

SELPA Solano County SELPA

Fiscal Year 2022–23

**TABLE 3****Federal, State, and Local Revenue Summary (Items D-7 to D-8)****D-7. Federal Categorical, State Categorical, and Local Unrestricted Funding**

Using the fields below, enter the projected funding by revenue jurisdiction. The "Total Revenue From All Sources" and the "Percentage of Total Funding" fields are automatically calculated.

Revenue Source	Amount	Percentage of Total Funding
Projected State Special Education Revenue	37,703,386	25.92%
Projected Federal Revenue	10,347,476	7.11%
Local Contribution	97,423,583	66.97%
<b>Total Revenue from all Sources:</b>	145,474,445	100.00%

**D-8. Attachment IV: Projected Revenue by Federal, State, and Local Funding Source by Local Educational Agency**

Using the CDE-approved template provided in **Attachment IV**, provide a complete distribution of revenues to all LEAs participating in the SELPA by federal and state funding source.

**D-9. Special Education Local Plan Area Allocation Plan**

- a. Describe the SELPA's allocation plan, including the process or procedure for allocating special education apportionments, including funds allocated to the RLA/AU/responsible person pursuant to *EC* Section 56205(b)(1)(A).

The are allocation models that provide off the top revenue for the County Office of Schools and the SELPA. From there funds are distributed to LEAs based on previous years Annual ADA.

- b. ☒ YES ☐ NO

If the allocation plan specifies that funds will be apportioned to the RLA/AU/AE, or to the SELPA administrator (for single LEA SELPAs), the administrator of the SELPA, upon receipt, distributes the funds in accordance with the method adopted pursuant to *EC* Section 56195.7(i). This allocation plan was approved according to the SELPA's local policymaking process and is consistent with SELPA's summarized policy statement identified in Local Plan Section B: Governance and Administration item B-4. If the response is "NO," then either Section D should be edited, or Section B must be amended according to the SELPA's adopted policy making process, and resubmitted to the COE and CDE for approval.

## Section D: Annual Budget Plan

SELPA Solano County SELPA

Fiscal Year 2022–23

**TABLE 4****Special Education Local Plan Area Expenditures (Items D-10 to D-11)****D-10. Regionalized Operations Budget**

Using the fields below, identify the total operating expenditures projected for the SELPA, exclusively. Expenditure line items are according SACS object codes. Include the projected amount budgeted for the SELPA's exclusive use. The "Percent of Total" expenses is automatically calculated. NOTE: Table 4 does not include district LEA, charter LEA, or COE LEA expenditures, there is no Attachment to be completed for Table 4.

Accounting Categories and Codes	Amount	Percentage of Total
Object Code 1000—Certificated Salaries	691,398	31.34%
Object Code 2000—Classified Salaries	295,961	13.41%
Object Code 3000—Employee Benefits	326,569	14.80%
Object Code 4000—Supplies	133,528	6.05%
Object Code 5000—Services and Operations	676,123	30.65%
Object Code 6000—Capital Outlay	0	0.00%
Object Code 7000—Other Outgo and Financing	82,649	3.75%
<b>Total Projected Operating Expenditures:</b>	<b>2,206,228</b>	<b>100.00%</b>

**D-11. Object Code 7000 --Other Outgo and Financing Description**

Include a description of the expenditures identified under "Object Code 7000—Other Outgo and Financing" by SACS codes. See Local Plan Guidelines for examples of possible entries.

Indirect Costs



## Section D: Annual Budget Plan

SELPA Solano County SELPA

Fiscal Year 2022–23

**TABLE 5****Supplemental Aids and Services and Students with Low Incidence Disabilities (D-12 to D-15)**

The standardized account code structure (SACS), goal 5760 is defined as "Special Education, Ages 5–22." Students with a low incidence (LI) disability are classified severely disabled. The LEA may elect to have locally defined goals to separate low-incidence disabilities from other severe disabilities to identify these costs locally.

**D-12. Defined Goals for Students with LI Disabilities**

Does the SELPA, including all LEAs participating in the SELPA, use locally defined goals to separate low-incidence disabilities from other severe disabilities?

☐ YES ☒ NO

If "No," describe how the SELPA identifies expenditures for low-incidence disabilities as required by *EC* Section 56205(b)(1)(D)?

LI costs area accounted for at the SELPA level. District submit expenses for reimbursement.

**D-13. Total Projected Expenditures for Supplemental Aids and Services in the Regular Classroom and for Students with LI Disabilities**

Enter the projected expenditures budgeted for Supplemental Aids and Services (SAS) disabilities in the regular education classroom.

247,020

**D-14. Total Projected Expenditures for Students with LI Disabilities**

Enter the total projected expenditures budgeted for students with LI disabilities.

815,500

**D-15. Attachment V: Projected Expenditures by LEA for SAS Provided to Students with Exceptional Needs in the Regular Classroom and Students with LI Disabilities**

Using the current CDE-approved template provided for Attachment V, enter the SELPA's projected funding allocations to each LEA for the provision of SAS to students with exceptional needs placed in the regular classroom setting and for those who are identified with LI disabilities. Information included in this table must be consistent with revenues identified in Section D, Table 5.

Special Education Local Plan Area (SELPA) Local Plan

SELPA Solano County SELPA

Fiscal Year 2022–23

**LOCAL PLAN**  
**Attachments**  
**SPECIAL EDUCATION LOCAL PLAN AREA**

California Department of Education  
Special Education Division  
2022–23 Local Plan Submission

INTENTIONALLY  
LEFT  
BLANK

Attachment I

SELPA:

Fiscal Year:

### Attachment I—Local Educational Agency Listing

#### Participating Local Educational Agency Identification

Enter the California Department of Education (CDE) issued county/district/school code (CDS) and the full name for each local educational agency (LEA) participating in the Local Plan. The LEA names will automatically populate the remaining attachments. Pursuant to California *Education Code (EC)* sections 56205(a)(12)(D)(iii) and 56195.1(b) and (c). SELPAs with one or more LEAs, or those who join with the county office of education (COE) to submit a Local Plan to the CDE for consideration of approval must include copies of joint powers agreements or contractual agreements, as appropriate.

In the table below, enter the CDE issued CDS code and the official name as listed in the California School Directory <https://www.cde.ca.gov/SchoolDirectory/> for each COE, District, Joint Powers Authority (JPA), and SELPA participating in the Local Plan and receiving a special education funding allocation for services and programs provided to students with disabilities.

#### To Add or Delete Rows:

To add or delete table rows, select the "plus" or "minus" buttons bellow. Actions taken here will be automatically repeated for each of the tables in Attachments II through VI. Users must manually enter LEA information in Attachment VII.

#### LEA Membership Changes:

If an LEA was previously reported to the CDE in fiscal year 2021–22 or 2022–23 and there is a change in SELPA membership, **DO NOT DELETE** the entry. Instead, under the "LEA Status" column, select the drop-down menu and choose the applicable status option for the LEA membership change.

#### SELPA County/District/School Codes

- If a SELPA does not have a CDS code, then the associated fields should be left blank. NOTE: If a CDS code section begins with a "0," the zero will not appear in the user's entry.
- If a SELPA does not have a complete CDS code, then leave the associated district and school code blank.
- If a SELPA is not a charter LEA, then leave the associated charter code blank.

Attachment I

SELPA:

Fiscal Year:

Add or Delete Row	List	County Code xx	District Code xxxxx	School Code xxxxxxx	Charter Code (if applicable) xxxx	LEA Official Name (District, Charter, COE, JPA, and SELPA)	Special Education Director First Name	Special Education Director Last Name	Phone (xxx) xxx-xxxx	Email	LEA Status
	1	48	70524			Benicia USD	Julie	Corona	707-747-8300	jcorona@beniciaunified.org	<b>Previously Reported</b>
	2	48	70532			Dixon USD	Kim	Parrott	707-693-6300	kim.parrott@dixonusd.org	<b>Previously Reported</b>
	3	48	70540			Fairfield-Suisun USD	Stavros	Gougoumis	707-399-5071	stavrosg@fsusd.org	<b>Previously Reported</b>
	4	48	70565			Travis USD	Deanna	Brownlee	707-437-4604	dbrownlee@travisusd.org	<b>Previously Reported</b>
	5	48	70573			Vacaville USD	Aumrey	Moland	707-453-7212	aumreym@vusd.solanocoe.k12.ca.us	<b>Previously Reported</b>
	6	48	10488			Solano COE	Siobhan	Dill	707-399-4866	sdill@solanocoe.net	<b>Previously Reported</b>

Attachment II

SELPA: Solano County SELPA

Fiscal Year: 2022–23

Each SELPA must adhere to requirements for developing and reporting special education budget revenue and expenditures. The following excerpt is taken from California School Accounting Manual (CSAM): Procedure 755 Special Education on page 755-1 and included to assist the SELPA with completing Section D: Annual Budget Plan information for each LEA participating in the SELPA's Local Plan.

Special education budgets are complex and are of great interest to the public, both locally and statewide. *EC* Section 56205(b)(1) requires that a special education budget shall identify particular elements. Identification of the following elements is facilitated by the standardized account code structure (SACS):

1. Apportionment received by the LEA in accordance with the allocation plan adopted by the SELPA. (The apportionment is tracked in SACS in the resource field in combination with the revenue code in the object field.)
2. Administrative costs of the plan. (These costs are tracked in the function field.)
3. Costs of special education services to pupils with severe disabilities and low-incidence disabilities. (This population is identified by the goal field.)
4. Costs of special education services to pupils with nonsevere disabilities. (This population is identified by the goal field.)
5. Costs of supplemental aids and services provided to meet the individual needs of pupils placed in regular education classrooms and environments. (Costs of these aids and services are tracked in the function field.)
6. Costs of regionalized operations and services and direct instructional support by program specialists in accordance with Part 30, Chapter 7.2, Article 6, of the California *EC*, Program Specialists and Administration of Regionalized Operations and Services. (These costs are tracked in the goal field for regionalized operations and in the function field for instructional services.)
7. Use of property taxes allocated to the SELPA pursuant to *EC* Section 2572. (Property taxes allocated to the SELPA are tracked in the resource field and identified by a revenue code in the object field.)

Attachment II

SELPA:

Fiscal Year:

**Attachment II—Projected Special Education Revenue by Local Educational Agency**

For each LEA participating in the Local Plan, enter the projected special education revenue funding sources allowed by the Individuals with Disabilities Education Act (IDEA). Information included in this table must be consistent with revenues identified in Section D, Table 1. NOTE: For fiscal year 2022–23, this Attachment is optional for single LEA SELPAs as the information has been provided in Section D, Table 1.

List	LEA Official Name (District, Charter, COE, JPA, and SELPA)	Assembly Bill (AB) 602 State Aid	AB 602 Property Tax	Federal IDEA Part C	Federal IDEA Part B	State Infant/ Toddler	State Mental Health	Federal Mental Health	Other Revenue	Subtotal
1	Benicia USD	1,106,308	0	0	854,599	0	291,737	52,098	0	2,304,742
2	Dixon USD	726,849	0	0	561,475	0	191,672	34,228	0	1,514,224
3	Fairfield-Suisun USD	5,060,274	0	0	3,908,951	0	1,334,408	238,297	0	10,541,930
4	Travis USD	1,319,249	0	0	1,019,092	0	347,890	62,125	0	2,748,356
5	Vacaville USD	3,086,872	0	0	2,384,541	0	814,017	145,365	0	6,430,795
6	Solano COE	16,954,700	6,392,307	47,966	1,017,962	0	77,103	0	20,777	24,510,815
Totals:		28,254,252	6,392,307	47,966	9,746,620	0	3,056,827	532,113	20,777	48,050,862

Attachment III

SELPA: Solano County SELPA

Fiscal Year: 2022–23

**Attachment III—Projected Expenditures by Object Code by Local Educational Agency**

For each LEA participating in the Local Plan, enter the projected special education expenditures by LEA and object code as allowed by the IDEA. Information included in this table must be consistent with expenditures identified in Section D, Tables 2 . NOTE: For fiscal year 2022–23, this Attachment is optional for single LEA SELPAs as the information has been provided in Section D, Table 2.

List	LEA Official Name (District, Charter, COE, JPA, and SELPA)	1000 Certificated Salaries	2000 Classified Salaries	3000 Employee Benefits	4000 Supplies	5000 Services and Operations	6000 Capital Outlay	7000 Other Outgo and Financing	Subtotal
1	Benicia USD	2,940,317	1,554,174	1,739,687	41,112	694,996	0	353,000	7,323,286
2	Dixon USD	1,424,820	1,674,098	1,580,426	164,145	1,728,940	0	29,225	6,601,654
3	Fairfield-Suisun USD	16,208,418	11,443,667	12,379,136	385,688	4,938,801	0	19,663	45,375,373
4	Travis USD	4,809,408	3,232,344	2,807,834	155,254	460,134	0	0	11,464,974
5	Vacaville USD	10,028,228	7,644,962	9,540,700	235,081	5,752,176		81,509	33,282,656
6	Solano COE	8,473,184	9,501,965	8,792,221	837,026	10,548,513	400,000	2,873,593	41,426,502
<b>Totals:</b>		43,884,375	35,051,210	36,840,004	1,818,306	24,123,560	400,000	3,356,990	145,474,445



Attachment IV

SELPA:

Fiscal Year:

**Attachment IV—Projected Revenue by Federal, State, and Local Funding Source by Local Educational Agency**

For each LEA participating in the Local Plan, enter the projected special education revenue received by each funding source. Information provided must be consistent with revenues identified in Section D, Table 3. NOTE: For fiscal year 2022–23, this Attachment is optional for single LEA SELPAs as the information has been provided in Section D, Table 3.

List	LEA Official Name (District, Charter, COE, JPA, and SELPA)	Federal Revenue	Percent of Total Federal Revenue	State Revenue	Percent of Total State Revenue	Local Revenue	Total Federal and State Funding
1	Benicia USD	906,697	8.76%	1,398,046	3.71%	5,018,543	2,304,743
2	Dixon USD	595,704	5.76%	918,521	2.44%	5,087,429	1,514,225
3	Fairfield-Suisun USD	4,147,248	40.08%	6,394,682	16.96%	34,833,443	10,541,930
4	Travis USD	1,081,217	10.45%	1,667,139	4.42%	8,716,618	2,748,356
5	Vacaville USD	2,529,907	24.45%	3,900,888	10.35%	26,851,861	6,430,795
6	Solano COE	1,086,703	10.50%	23,424,110	62.13%	16,915,689	24,510,813
Totals:		10,347,476	100.00%	37,703,386	100.00%	97,423,583	48,050,862

Attachment V

SELPA:

Fiscal Year:

**Attachment V—Projected Expenditures by Local Educational Agency for Supplemental Aids and Services in the Regular Classroom for Students with Disabilities and Those Identified with Low Incidence Disabilities**

Enter the revenue allocated to each LEA for supplemental aids and services (SAS) for those students with disabilities placed in the regular classroom setting and those who are identified with low incidence (LI) disabilities. Information included in this table must be consistent with revenues identified in Section D, Table 5. NOTE: For fiscal year 2022–23, this Attachment is optional for single LEA SELPAs as the information has been provided in Section D, Table 5.

List	LEA Official Name (District, Charter, COE, JPA, and SELPA)	Total Projected Expenditures by LEA SAS in the Regular Classroom	Total Projected Expenditures by LEA for LI
1	Benicia USD	0	0
2	Dixon USD	124,072	0
3	Fairfield-Suisun USD	75,850	0
4	Travis USD	0	0
5	Vacaville USD	47,098	0
6	Solano COE	0	815,500
Totals:		247,020	815,500

Attachment VI

SELPA: Solano County SELPA

Fiscal Year: 2022–23

Attachment VI  
must be  
completed  
using the CDE  
approved  
Microsoft Excel  
Template

Attachment VII

SELPA:

Fiscal Year:

**Attachment VII—Special Education Local Plan Area Membership Transfers and Mergers (to and from the SELPA)**

Educational programs and services already in operation may not be transferred to another LEA unless all provisions of *EC* Section 56207 have been met by the SELPA as demonstrated by the completion and submission of Attachment VII. The effective date of the transfer must not be prior to the July 1 of the second fiscal year after the date the sending or receiving SELPA informed the other agency and the governing body of multiple LEA SELPAs or the responsible individual of single LEA SELPAs notified the other agency, unless both the sending and receiving SELPA unanimously agree the transfer date will take effect on the July 1 of the first fiscal year following the notification date.

LEA Name	Add or Delete Row	LEA Status	Impacted SELPA Name	Impacted District, Charter, or School Name	Initiating SELPA Notification Date	SELPA Governing Board Notification Date	COE Notification Date	CDE Notification Date	Agreed Upon Effective Fiscal Year
Benicia USD		Delete This Row							<input type="text"/>
Dixon USD		Delete This Row							<input type="text"/>
Fairfield-Suisun USD		Delete This Row							<input type="text"/>
Travis USD		Delete This Row							<input type="text"/>
Vacaville USD		Delete This Row							<input type="text"/>
Solano COE		Delete This Row							<input type="text"/>

Special Education Local Plan Area (SELPA) Local Plan

SELPA Solano County SELPA

Fiscal Year 2022–23

**LOCAL PLAN**  
**Section E: Annual Service Plan**  
**SPECIAL EDUCATION LOCAL PLAN AREA**



California Department of Education  
Special Education Division  
2021–22 Local Plan Annual Submission

## Section E: Annual Service Plan

SELPA: Solano County SELPA

Fiscal Year: 2022–23

### Local Plan Section E: Annual Service Plan

California *Education Code (EC)* sections 56205(b)(2) and (d); 56001; and 56195.9

The Local Plan Section E: Annual Service Plan must be adopted at a public hearing held by the SELPA. Notice of this hearing shall be posted in each school in the SELPA at least 15 days before the hearing. Local Plan Section E: Annual Service Plan may be revised during any fiscal year according to the SELPA's process as established and specified in Section B: Governance and Administration portion of the Local Plan consistent with *EC* sections 56001(f) and 56195.9. Local Plan Section E: Annual Service Plan must include a description of services to be provided by each local educational agency (LEA), including the nature of the services and the physical location where the services are provided (Attachment VI), regardless of whether the LEA is participating in the Local Plan.

#### Services Included in the Local Plan Section E: Annual Service Plan

All entities and individuals providing related services shall meet the qualifications found in Title 34 of the *Code of Federal Regulations (34 CFR)* Section 300.156(b), Title 5 of the *California Code of Regulations (5 CCR)* 3001(r) and the applicable portions 3051 et. seq.; and shall be either employees of an LEA or county office of education (COE), employed under contract pursuant to *EC* sections 56365-56366, or employees, vendors or contractors of the State Departments of Health Care Services or State Hospitals, or any designated local public health or mental health agency. Services provided by individual LEAs and school sites are to be included in **Attachment VI**.

**Include a description each service provided. If a service is not currently provided, please explain why it is not provided and how the SELPA will ensure students with disabilities will have access to the service should a need arise.**

#### ☒ 330—Specialized Academic Instruction

Provide a detailed description of the services to be provided under this code.

Adapting, as appropriate, to the needs of the child with a disability the content, methodology, or delivery of instruction to ensure access of the child to the general curriculum, so that he or she can meet the educational standards within the jurisdiction of the public agency that apply to all children. (34 CFR 300.39(b)(3)).

Section E: Annual Service Plan

SELPA: Solano County SELPA

Fiscal Year: 2022–23

☒ 210–Family Training, Counseling, Home  
Visits (Ages 0-2 only)

☐ *Service is Not Currently Provided*

Provide a detailed description of the services to be provided under this code.

This service includes: services provided by social workers, psychologists, or other qualified personnel to assist the family in understanding the special needs of the child and enhancing the child's development.

☐ 220–Medical (Ages 0-2 only)

☒ *Service is Not Currently Provided*

Include an explanation as to why the service option is not included as part of the SELPA's continuum of services available to students with disabilities.

**Attachment VII - Specialized Academic Instruction and Related Services by School Site**

☐ 230–Nutrition (Ages 0-2 only)

☒ *Service is Not Currently Provided*

Include an explanation as to why the service option is not included as part of the SELPA's continuum of services available to students with disabilities.

There are currently no students in the SELPA with an IFSP requiring this service.

☒ 240–Service Coordination (Ages 0-2 only)

☐ *Service is Not Currently Provided*

Provide a detailed description of the services to be provided under this code.

This service includes the coordination of special education and related services.

☒ 250–Special Instruction (Ages 0-2 only)

☐ *Service is Not Currently Provided*

Provide a detailed description of the services to be provided under this code.

Special instruction includes: the design of learning environments and activities that promote the child's acquisition of skills in a variety of developmental areas, including cognitive processes and social interaction; curriculum planning, including the planned interaction of personnel, materials, and time and space, that leads to achieving the outcomes in the child's Individual Family Service Plan (IFSP); providing families with information, skills, and support related to enhancing the skill development of the child; and working with the child to enhance

Section E: Annual Service Plan

SELPA: Solano County SELPA

Fiscal Year: 2022–23

the child's development.

☐ 260–Special Education Aide (Ages 0-2 only) ☒ *Service is Not Currently Provided*

Include an explanation as to why the service option is not included as part of the SELPA's continuum of services available to students with disabilities.

There are currently no students in the SELPA with an IEP or IFSP requiring this service.

☐ 270–Respite Care (Ages 0-2 only) ☒ *Service is Not Currently Provided*

Include an explanation as to why the service option is not included as part of the SELPA's continuum of services available to students with disabilities.

There are currently no students in the SELPA with an IEP or IFSP requiring this service.

☒ 340–Intensive Individual Instruction

Provide a detailed description of the services to be provided under this code.

Individualized Education Program (IEP) Team determination that student requires additional support for all or part of the day to meet his or her IEP goals.

☒ 350–Individual and Small Group Instruction

Provide a detailed description of the services to be provided under this code.

Instruction delivered one-to-one or in a small group as specified in an IEP enabling the individual(s) to participate effectively in the total school program (30 EC 56441.2, 5 CCR 305.1)

☒ 415–Speech and Language ☐ *Service is Not Currently Provided*

Provide a detailed description of the services to be provided under this code.

Services provide remedial intervention for eligible individuals with difficulty understanding or using spoken language. The difficulty may result from problems with articulation (excluding abnormal swallowing patterns, if that is the sole assessed disability); abnormal voice quality, pitch, or loudness; fluency; hearing loss; or the acquisition, comprehension, or expression of



Section E: Annual Service Plan

SELPA: Solano County SELPA

Fiscal Year: 2022–23

spoken language. Language deficits or speech patterns resulting from unfamiliarity with the English language and from environmental, economic, or cultural factors are not included. Services include: specialized instruction and services, monitoring, reviewing, and consultation. Services may be direct or indirect including the use of a speech consultant.

☒ 425–Adapted Physical Education

☐ *Service is Not Currently Provided*

Provide a detailed description of the services to be provided under this code.

Direct physical education services provided by an adapted physical education specialist to pupils who have needs that cannot be adequately satisfied in other physical education programs as indicated by assessment and evaluation of motor skills performance and other areas of need. It may include individually designed developmental activities, games, sports and rhythms, for strength development and fitness, suited to the capabilities, limitations, and interests of individual students with disabilities who may not safely, successfully or meaningfully engage in unrestricted participation in the vigorous activities of the general or modified physical education program. (CCR Title 5 §3051.5).

☒ 435–Health and Nursing: Specialized  
Physical Health Care

☐ *Service is Not Currently Provided*

Provide a detailed description of the services to be provided under this code.

Health care services means those health services prescribed by the child's licensed physician and/or surgeon, requiring medically related training of the individual who performs the services and which are necessary during the school day to enable the child to attend school (CCR §3051.12(b)(1)(A)). Specialized physical health care services include but are not limited to suctioning, oxygen administration, catheterization, nebulizer treatments, insulin administration and glucose testing (CEC 49423.5 (d)).

☒ 436–Health and Nursing: Other

☐ *Service is Not Currently Provided*

Provide a detailed description of the services to be provided under this code.

This includes services that are provided to individuals with exceptional needs by a qualified individual pursuant to an IEP when a student has health problems which require nursing intervention beyond basic school health services. Services include managing the health problem, consulting with staff, group and individual counseling, making appropriate referrals, and maintaining communication with agencies and health care providers. These services do not include any physician-supervised or specialized health care service. IEP-required health and nursing services are expected to supplement the regular health services program. (34 CFR 300.34; CCR Title 5 §3051.12 (a)).

Section E: Annual Service Plan

SELPA: Solano County SELPA

Fiscal Year: 2022–23

☒ 445–Assistive Technology

☐ *Service is Not Currently Provided*

Provide a detailed description of the services to be provided under this code.

Any specialized training or technical support for the incorporation of assistive devices, adapted computer technology, or specialized media with the educational programs to improve access for students. The term includes a functional analysis of the student's needs for assistive technology; selecting, designing, fitting, customizing, or repairing appropriate devices; coordinating services with assistive technology devices; training or technical assistance for students with a disability, the student's family, individuals providing education or rehabilitation services, and employers. (34 CFR Part 300.6).

☒ 450–Occupational Therapy

☐ *Service is Not Currently Provided*

Provide a detailed description of the services to be provided under this code.

Includes services to improve student's educational performance, postural stability, self-help abilities, sensory processing and organization, environmental adaptation and use of assistive devices, motor planning and coordination, visual perception and integration, social and play abilities, and fine motor abilities. Both direct and indirect services may be provided within the classroom, other educational settings or the home; in a group or on an individual basis; and may include therapeutic techniques to develop abilities; adaptations to the student's environment or curriculum; and consultation and collaboration with other staff and parents. Services are provided, pursuant to an Individualized Education Program (IEP), by a qualified occupational therapist registered with the American Occupational Therapy Certification Board. (CCR Title 5 §. 3051.6, EC Part 30 §56363).

☒ 460–Physical Therapy

☐ *Service is Not Currently Provided*

Provide a detailed description of the services to be provided under this code.

These services are provided, pursuant to an Individualized Education Program (IEP), by a registered physical therapist, or physical therapist assistant, when assessment shows a discrepancy between gross motor performance and other educational skills. Physical therapy includes, but is not limited to, motor control and coordination, posture and balance, self-help, functional mobility, accessibility and use of assistive devices. Services may be provided within the classroom, other educational settings or in the home; and may occur in groups or individually. These services may include adaptations to the student's environment and curriculum, selected therapeutic techniques and activities, and consultation and collaborative interventions with staff and parents. (B&PC Ch. 5.7, CCR Title 5 §3051.6, EC Part 30 §56363, GC-Interagency Agreements Ch. 26.5 §7575(a)(2)).

Section E: Annual Service Plan

SELPA: Solano County SELPA

Fiscal Year: 2022–23

☒ 510–Individual Counseling

Provide a detailed description of the services to be provided under this code.

One-to-one counseling, provided by a qualified individual pursuant to an IEP. Counseling may focus on aspects, such as educational, career, personal; or be with parents or staff members on learning problems or guidance programs for students. Individual counseling is expected to supplement the regular guidance and counseling program. (34 CFR § 300.24(b)(2), (CCR Title 5 §3051.9).

☒ 515–Counseling and Guidance

☐ *Service is Not Currently Provided*

Provide a detailed description of the services to be provided under this code.

Counseling in a group setting, provided by a qualified individual pursuant to an IEP. Group counseling is typically social skills development, but may focus on aspects, such as educational, career, personal; or be with parents or staff members on learning problems or guidance programs for students. IEP-required group counseling is expected to supplement the regular guidance and counseling program. (34 CFR §300.24.(b)(2)); CCR Title 5 §3051.9) Guidance services include interpersonal, intrapersonal or family interventions, performed in an individual or group setting by a qualified individual pursuant to an IEP. Specific programs include social skills development, self-esteem building, parent training, and assistance to special education students supervised by staff credentialed to serve special education students. These services are expected to supplement the regular guidance and counseling program. (34 CFR 300.306; CCR Title 5 §3051.9).

☒ 520–Parent Counseling

☐ *Service is Not Currently Provided*

Provide a detailed description of the services to be provided under this code.

Individual or group counseling provided by a qualified individual pursuant to an Individualized Education Program (IEP) to assist the parent(s) of special education students in better understanding and meeting their child's needs; may include parenting skills or other pertinent issues. IEP-required parent counseling is expected to supplement the regular guidance and counseling program. (34 CFR §300.31(b)(7); CCR Title 5 §3051.11).

☒ 525–Social Worker

☐ *Service is Not Currently Provided*

Section E: Annual Service Plan

SELPA: Solano County SELPA

Fiscal Year: 2022–23

Provide a detailed description of the services to be provided under this code.

Services provided pursuant to an Individualized Education Program (IEP) by a qualified individual, includes, but are not limited to, preparing a social or developmental history of a child with a disability; group and individual counseling with the child and family; working with those problems in a child's living situation (home, school, and community) that affect the child's adjustment in school; and mobilizing school and community resources to enable the child to learn as effectively as possible in his or her educational program. Social work services are expected to supplement the regular guidance and counseling program. (34 CFR §300.24(b)(13); CCR Title 5 §3051.13).

☒ 530–Psychological

☐ *Service is Not Currently Provided*

Provide a detailed description of the services to be provided under this code.

These services, provided by a credentialed or licensed psychologist pursuant to an Individualized Education Program (IEP), include interpreting assessment results to parents and staff in implementing the IEP; obtaining and interpreting information about child behavior and conditions related to learning; planning programs of individual and group counseling and guidance services for children and parents. These services may include consulting with other staff in planning school programs to meet the special needs of children as indicated in the IEP. (CFR Part 300 §300.24). IEP-required psychological services are expected to supplement the regular guidance and counseling program. (34 CFR §300.24; CCR Title 5 §3051.10).

☒ 535–Behavior Intervention

☐ *Service is Not Currently Provided*

Provide a detailed description of the services to be provided under this code.

A systematic implementation of procedures designed to promote lasting, positive changes in the student's behavior resulting in greater access to a variety of community settings, social contacts, public events, and placement in the least restrictive environment. (CCR Title 5 §3001(d)).

☒ 540–Day Treatment

Provide a detailed description of the services to be provided under this code.

Structured education, training and support services to address the student's mental health needs. (Health & Safety Code, Div.2, Chap.3, Article 1, 1502(a)(3)).

Section E: Annual Service Plan

SELPA: Solano County SELPA

Fiscal Year: 2022–23

☒ 545–Residential Treatment

Provide a detailed description of the services to be provided under this code.

A 24-hour out-of-home placement that provides intensive therapeutic services to support the educational program. (Welfare and Institutions Code, Part 2, Chapter 2.5, Art. 1, §5671)).

☒ 610–Specialized Service for Low Incidence Disabilities

☐ Service is Not Currently Provided

Provide a detailed description of the services to be provided under this code.

Low incidence services are defined as those provided to the student population of orthopedically impaired (OI), visually impaired (VI), deaf, hard of hearing (HH), or deaf-blind (DB). Typically, services are provided in education settings by an itinerant teacher or the itinerant teacher/specialist. Consultation is provided to the teacher, staff and parents as needed. These services must be clearly written in the student's Individualized Education Program (IEP), including frequency and duration of the services to the student. (CCR Title 5 §3051.16 & 3051.18).

☒ 710–Specialized Deaf and Hard of Hearing

☐ Service is Not Currently Provided

Provide a detailed description of the services to be provided under this code.

These services include speech therapy, speech reading, auditory training and/or instruction in the student's mode of communication. Rehabilitative and educational services; adapting curricula, methods, and the learning environment; and special consultation to students, parents, teachers, and other school personnel may also be included. (CCR Title 5 §3051.16 and 3051.18).

☒ 715–Interpreter

☐ Service is Not Currently Provided

Provide a detailed description of the services to be provided under this code.

Sign language interpretation of spoken language to individuals, whose communication is normally sign language, by a qualified sign language interpreter. This includes conveying information through the sign system of the student or consumer and tutoring students regarding class content through the sign system of the student. (CCR Title 5§3051.16)

Section E: Annual Service Plan

SELPA: Solano County SELPA

Fiscal Year: 2022–23

☒ 720–Audiological

☐ *Service is Not Currently Provided*

Provide a detailed description of the services to be provided under this code.

These services include measurements of acuity, monitoring amplification, and frequency modulation system use. Consultation services with teachers, parents or speech pathologists must be identified in the Individualized Education Program (IEP) as to reason, frequency and duration of contact; infrequent contact is considered assistance and would not be included. (CCR Title 5 §3051.2).

☒ 725–Specialized Vision

☐ *Service is Not Currently Provided*

Provide a detailed description of the services to be provided under this code.

This is a broad category of services provided to students with visual impairments. It includes assessment of functional vision; curriculum modifications necessary to meet the student's educational needs, including Braille, large type, and aural media; instruction in areas of need; concept development and academic skills; communication skills (including alternative modes of reading and writing); social, emotional, career, vocational, and independent living skills. It may include coordination of other personnel providing services to the students (such as transcribers, readers, counselors, orientation and mobility specialists, career/vocational staff, and others) and collaboration with the student's classroom teacher. (CAC Title 5 §3030(d), EC 56364.1).

☒ 730–Orientation and Mobility

☐ *Service is Not Currently Provided*

Provide a detailed description of the services to be provided under this code.

Students with identified visual impairments are trained in body awareness and to understand how to move. Students are trained to develop skills to enable them to travel safely and independently around the school and in the community. It may include consultation services to parents regarding their children requiring such services according to an Individualized Education Program (IEP).

☒ 735–Braille Transcription

☐ *Service is Not Currently Provided*

Provide a detailed description of the services to be provided under this code.

Any transcription services to convert materials from print to Braille. It may include textbooks, tests, worksheets, or anything necessary for instruction. The transcriber should be qualified in

Section E: Annual Service Plan

SELPA: Solano County SELPA

Fiscal Year: 2022–23

English Braille as well as Nemeth Code (mathematics) and be certified by appropriate agency.

☐ 740–Specialized Orthopedic

☒ *Service is Not Currently Provided*

Include an explanation as to why the service option is not included as part of the SELPA's continuum of services available to students with disabilities.

There are currently no students in the SELPA with an IEP or IFSP requiring this service.

☐ 745–Reading

☒ *Service is Not Currently Provided*

Include an explanation as to why the service option is not included as part of the SELPA's continuum of services available to students with disabilities.

There are currently no students in the SELPA with an IEP or IFSP requiring this service.

☐ 750–Note Taking

☒ *Service is Not Currently Provided*

Include an explanation as to why the service option is not included as part of the SELPA's continuum of services available to students with disabilities.

There are currently no students in the SELPA with an IEP or IFSP requiring this service.

☐ 755–Transcription

☒ *Service is Not Currently Provided*

Include an explanation as to why the service option is not included as part of the SELPA's continuum of services available to students with disabilities.

There are currently no students in the SELPA with an IEP or IFSP requiring this service.

☐ 760–Recreation Service, Including  
Therapeutic Recreation

☒ *Service is Not Currently Provided*

Include an explanation as to why the service option is not included as part of the SELPA's continuum of services available to students with disabilities.

There are currently no students in the SELPA with an IEP or IFSP requiring this service.



Section E: Annual Service Plan

SELPA: Solano County SELPA

Fiscal Year: 2022–23

☒ 820–College Awareness

☐ *Service is Not Currently Provided*

Provide a detailed description of the services to be provided under this code.

The result of acts that promote and increase student learning about higher education opportunities, information and options that are available including, but not limited to, career planning, course prerequisites, admission eligibility and financial aid.

☒ 830–Vocational Assessment, Counseling,  
Guidance, and Career Assessment

☐ *Service is Not Currently Provided*

Provide a detailed description of the services to be provided under this code.

Organized educational programs that are directly related to the preparation of individuals for paid or unpaid employment and may include provision for work experience, job coaching, development and/or placement, and situational assessment. This includes career counseling to assist student in assessing his/her aptitudes, abilities, and interests in order to make realistic career decisions. (Title 5 §3051.14).

☒ 840–Career Awareness

☐ *Service is Not Currently Provided*

Provide a detailed description of the services to be provided under this code.

Transition services include a provision in paragraph (1)(c)(vi), self-advocacy, career planning, and career guidance. There is a need for coordination between this provision and the Perkins Act to ensure that students with disabilities in middle schools will be able to access vocational education funds. (34 CFR-§300.29).

☒ 850–Work Experience Education

☐ *Service is Not Currently Provided*

Provide a detailed description of the services to be provided under this code.

Organized educational programs that are directly related to the preparation of individuals for paid or unpaid employment, or for additional preparation for a career requiring other than a baccalaureate or advanced degree. (34 CFR 300.26).

☒ 855–Job Coaching

☐ *Service is Not Currently Provided*



## Section E: Annual Service Plan

SELPA: Solano County SELPA

Fiscal Year: 2022–23

Provide a detailed description of the services to be provided under this code.

A service that provides assistance and guidance to an employee who may be experiencing difficulty with one or more aspects of the daily job tasks and functions. The service is provided by a job coach who is highly successful, skilled, and trained on the job who can determine how the employee that is experiencing difficulty learns best and formulate a training plan to improve job performance.

☒ 860–Mentoring

☐ *Service is Not Currently Provided*

Provide a detailed description of the services to be provided under this code.

A sustained coaching relationship between a student and teacher through on-going involvement and offers support, guidance, encouragement, and assistance as the learner encounters challenges with respect to a particular area such as acquisition of job skills. Mentoring can be either formal as in planned, structured instruction or informal that occurs naturally through friendship, counseling and collegiality in a casual, unplanned way.

☒ 865–Agency Linkages (referral and placement)

☐ *Service is Not Currently Provided*

Provide a detailed description of the services to be provided under this code.

Service coordination and case management that facilitates the linkage of individualized education programs under this part and individualized family service plans under part C with individualized service plans under multiple Federal and State programs, such as Title I of the Rehabilitation Act of 1973 (vocational rehabilitation), Title XIX of the Social Security Act (Medicaid), and Title XVI of the Social Security Act (supplemental security income). (34 CFR §613).

☐ 870–Travel and Mobility Training

☒ *Service is Not Currently Provided*

Include an explanation as to why the service option is not included as part of the SELPA's continuum of services available to students with disabilities.

There are currently no students in the SELPA with an IEP or IFSP requiring this service.

☒ 890–Other Transition Services

☐ *Service is Not Currently Provided*

Section E: Annual Service Plan

SELPA: Solano County SELPA

Fiscal Year: 2022–23

Provide a detailed description of the services to be provided under this code.

These services may include program coordination, case management and meetings, and crafting linkages between schools and between schools and postsecondary agencies.

☒ 900–Other Related Service

Pursuant to Title 5 of the *California Code of Regulations* (5 CCR) 3051.24, "other related services" not identified in sections 5 CCR sections 3051.1 through 3051.23 must be provided only by staff who possess a license to perform the service issued by an entity within the Department of Consumer Affairs or another state licensing office; or by staff who hold an credential issued by the California Commission on Teacher Credentialing authorizing the service. If code 900 is used, include the information below. Users may select the "+" and "-" buttons to add or delete responses.



Description of the "Other Related Service"

Music Therapy

Qualifications of the Provider Delivering "Other Related Service"

Music Therapy is provided by qualified personnel who possess a Board Certified credential from the Certification Board for Music Therapists.

**Attachment VI—Specialized Academic Instruction (SAI)/Specially Designed Instruction (SDI) and Related Services**

Enter all special education Services provided by the SELPA's LEA membership and location (site) where they are provided. If code 900 is selected, the specific special education service must be defined in Local Plan Section E: Annual Service Plan. Licensing, certification, and provider qualifications for each identified service must be in accordance with law (see the Local Plan Guidance Document for more information). Attachment VI must be included with each Local Plan Section E: Annual Service Plan submission to the California Department of Education (CDE).

DATE: 4/19/2022

FISCAL YEAR: 2022-23

SELPA NAME: Solano County SELPA

For each LEA school/site name identified in "Column A," place an "x" in the corresponding instructional and/or relate

[illegible]

[illegible]

[illegible]

[illegible]

CDE Official Local Educational Agency Name		County/District/ School Code (xx-xxxxx->xxxxxxx)	Charter Number (if applicable) (xxxx)	330	210	220	230	240	250	260	270	340	350	415	425	435	436	445	450	460	510	515	520	525	530	535	540	545	610	710	715	720	725	730	735	740	745	750	755	760	820	830	840	850	855	860	865	870	890	900						
Vacaville Unified School District	NPS-Kadian LLC - Land Park Campus	48-70573-0115220		x										x					x																								x	x												
Vacaville Unified School District	NPS-Lattice Educational Services	48-70573-7089113		x										x					x																																x					
Vacaville Unified School District	NPS-Point Quest - Sacramento	48-70573-7051394		x										x							x	x																					x		x											
Vacaville Unified School District	NPS-Sierra Lower - (K-8)	48-70573-6130025		x										x					x	x	x						x																													
Vacaville Unified School District	NPS-Sierra School (Solano)	48-70573-6204887		x								x		x						x	x						x																	x		x										
Vacaville Unified School District	NPS-Sierra Upper School in Sacrament (9-12)	48-70573-6152979		x										x																																						x				
Vacaville Unified School District	NPS-Spectrum (Solano)	48-70573-6201842		x								x	x	x			x		x		x						x																										x			
Vacaville Unified School District	NPS-Spectrum - Concord	48-70573-6933501		x								x		x									x																																	
Vacaville Unified School District	Orchard Elementary	48-70573-6097950		x								x	x	x	x				x	x	x	x				x	x																													
Vacaville Unified School District	Sierra Vista	48-70573-0133553		x										x	x			x	x		x					x					x																									
Vacaville Unified School District	Vaca Pena Middle	48-70573-6106363		x								x		x					x		x					x	x																													
Vacaville Unified School District	Vacaville Christian School	48-70573-6996425		x										x							x											x																							x	
Vacaville Unified School District	Vacaville High	48-70573-4837803		x								x		x	x			x			x	x	x			x	x				x				x	x																			x	
Vacaville Unified School District	Will C. Wood High	48-70573-4830089		x								x		x	x				x		x	x				x	x				x				x	x																		x		
Vacaville Unified School District																																																								

## R. SCOE Regional Programs

SCOE Regional Programs include:

1. Moderate – Severe Program
2. Assistive Technology (AT) Services
3. Deaf/Hard of Hearing (DHH) Program and Services
4. Physical Therapy (PT) Services
5. Adult Transition Program
6. Structured Class for Intensive Learning (SCIL), operated by SCOE

The Council of Superintendents (COS) annually approves funding for Solano County Office of Education (SCOE) to operate the Moderate-Severe Program, Assistive Technology (AT) Services, the DHH program, Physical Therapy, and the Adult Transition Program, and to provide necessary special education and related services to students at the Solano County Juvenile Detention Facility. In the event SCOE requires a budget augmentation during the fiscal year for these programs, approval will be sought through the COS. SCOE shall maintain a reserve of 3% of projected expenditures. Unspent fund balance identified at closing in the subsequent year shall be distributed to the member district based upon ADA.

Physical Therapy (PT) Services provided by SCOE to students not enrolled in a SCOE moderate-severe program is funded on a per pupil cost-recovery basis by member districts utilizing the service. Structured Class for Intensive Learning (SCIL), operated by SCOE, is funded on a per pupil cost-recovery basis by member districts utilizing the service.

The District of Special Education Accountability maintains responsibility for the provision of a Free Appropriate Public Education for its students wherever they are served.

Moved (insertion) [1]

Deleted: specific regionally available special education programs

Deleted: s

Deleted: ,

Deleted: ¶

Moved up [1]: SCOE Regional Programs include:¶

¶ Moderate – Severe Program¶

¶ Assistive Technology (AT) Services¶

¶ Deaf/Hard of Hearing (DHH) Program and Services¶

¶ Physical Therapy (PT) Services¶

¶ Adult Transition Program¶

¶ Structured Class for Intensive Learning (SCIL), operated by SCOE¶



**SCOE TRANSPORTATION**

2022/2023 TRANSPORTATION BUDGET

	2021/2022 Adopted Budget	2021/2022 Revised Budget	2022/2023 Projected Budget	Proposed Inc (Dec) Adopted	Proposed Inc (Dec) Revised
<b>Revenue:</b>					
Apportionment	937,834	937,834	937,834	-	-
SCOE Contribution to Indirect>5%	93,965	88,437	97,747	3,782	9,310
<b>Revenue Total</b>	<b>1,031,799</b>	<b>1,026,271</b>	<b>1,035,581</b>	<b>3,782</b>	<b>9,310</b>
<b>Expenditures:</b>					
Salaries and Benefits					
2000 Classified	920,506	786,252	942,220	21,714	155,968
3000 Benefits	501,002	414,501	527,823	26,821	113,322
Total Salaries and Benefits	1,421,508	1,200,753	1,470,043	48,535	269,290
4000 Books/Supplies					
Fuel	120,000	160,000	150,000	30,000	(10,000)
Other Supplies	24,575	58,142	42,675	18,100	(15,467)
Total Books/Supplies	144,575	218,142	192,675	48,100	(25,467)
5000 Services/Other Op Exp					
Vehicle Rentals	100,000	22,942	100,000	-	77,058
Maintenance/Toll/Uniforms	80,000	159,371	155,100	75,100	(4,271)
Repairs	21,000	61,675	65,000	44,000	3,325
Software	12,000	9,340	10,000	(2,000)	660
Conference/Travel	3,000	2,640	2,700	(300)	60
Operations	21,467	32,580	28,213	6,746	(4,367)
Total 5000 Services & Other	237,467	288,548	361,013	123,546	72,465
6000 Capital Outlay	-	-	-	-	-
7000 Other Outgo					
Bus payment	31,542	35,902	48,894	17,352	12,992
Indirect	90,178	84,872	101,187	11,009	16,315
Indirect over 5%	93,965	88,437	97,747	3,782	9,310
Total 7000 Other Outgo	215,685	209,211	247,828	32,143	38,617
<b>Expenditures Total</b>	<b>2,019,235</b>	<b>1,916,654</b>	<b>2,271,559</b>	<b>252,324</b>	<b>354,905</b>
Reserve	60,577	29,658	65,215	4,638	35,557
<b>Total</b>	<b>2,079,812</b>	<b>1,946,312</b>	<b>2,336,774</b>	<b>256,962</b>	<b>390,462</b>
<b>Excess Cost</b>	<b>1,048,013</b>	<b>920,041</b>	<b>1,301,193</b>	<b>253,180</b>	<b>381,152</b>

	Adopted FTE 21-22	Proposed FTE 22-23	Proposed-Adopted
Transportation Manager	1.00	1.00	-
Bus Driver Instructor	1.00	1.00	-
Dispatch/Office Technician	1.00	1.00	-
Bus Drivers	13.49	13.57	0.08
Transportation Assistant	3.43	3.71	0.28
Maintenance/Custodial	0.13	0.13	-
<b>Total FTE</b>	<b>20.05</b>	<b>20.41</b>	<b>0.36</b>

**22/23 Projections:****Annual Miles****37,050** \*Based on 21/22 Usage**Cost/Mile In-District****63.07** \*Total Expenses / Annual Miles**Cost/Mile Out of Dist.****35.12** \*(Excess Cost - In-District Cost) / Out of District Miles

District	In-District Miles	In-District Cost	Out of Dist. Miles	Out of Dist. Cost	Total Cost
Benicia USD	-	-	-	\$0	-
Dixon USD	-	-	9,589	\$336,765	\$336,765
Fairfield USD	-	-	8,500	\$298,519	\$298,519
Travis USD	-	-	8,374	\$294,094	\$294,094
Vacaville USD	-	-	10,587	\$371,815	\$371,815
	-	-	<b>37,050</b>	<b>\$1,301,193</b>	<b>\$1,301,193</b>

Note: 22/23 Budget includes the one time cost of Zonar equipment refresh